

23239 KMI-R-3/125A

Modular switch disconnector

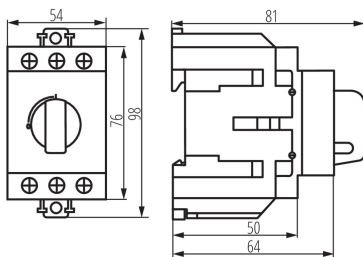

GENERAL DATA:

Utilisation category: AC-22A / AC-23A

Place of application: Indoors

Norm: PN-EN 60947-3

Length [mm]: 81

Width [mm]: 54

Height [mm]: 98

TECHNICAL DATA:

Rated voltage [V]: 415 AC

Rated current [A]: 125

Rated frequency [Hz]: 50

Connection type: Terminal block

Range of sections of wires used [mm²]: 1-25

Control type: mechaniczne

Number of modules: 3

IP class: 20

Rated insulation voltage U_i [V]: 800

Rated impulse withstand voltage U_{imp} [V]: 6000

Rated operational current I_e [A]: 125 (AC-22A) / 80 (AC-23A)

Number of poles: 3

Thermal current I_{th} [A]: 125